

## Error Message: No CODA Device is Found

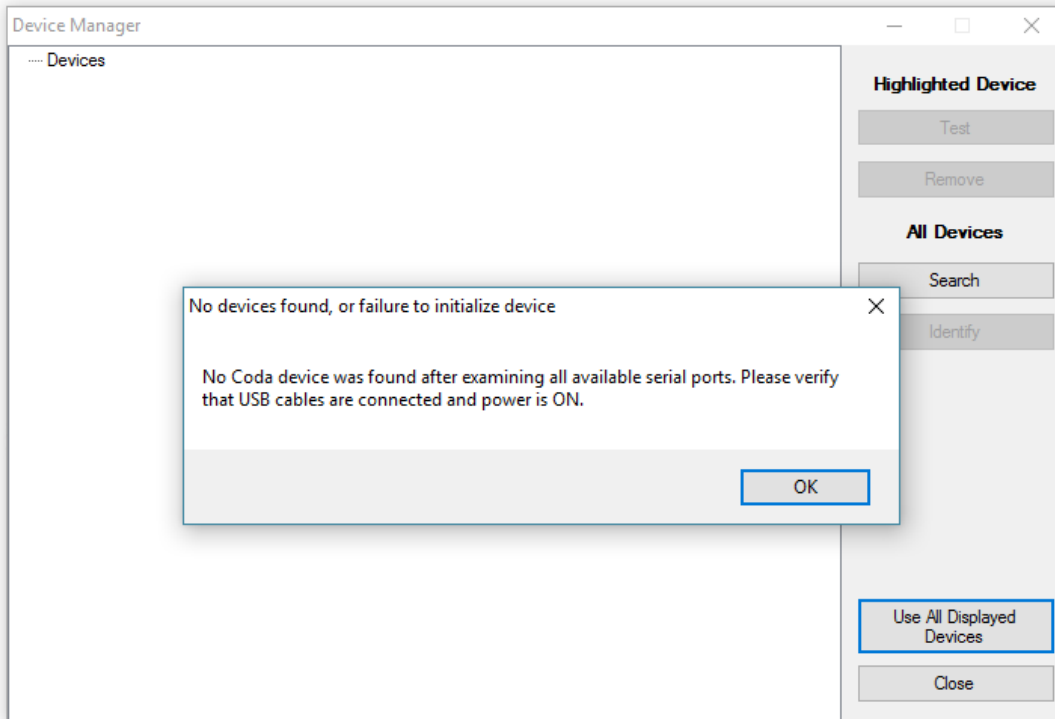

1. Close all open windows on your PC, including the CODA Software.
2. Connect your CODA to the PC and turn the CODA on.
  - a. Does the red light on the CODA illuminate? Are you able to hear the system “clicking” or making other sounds as it pressurizes upon startup?
    - i. If no, be sure that your CODA is plugged in with the 18V power supply.
3. Reopen the CODA software.
4. If the device is still not found, check to be sure that your PC recognizes the CODA device. Open Device Manager, then COM Ports. Is the CODA listed?